

AERA 2" REFLEX CYLINDER

NEW CONSTRUCTION

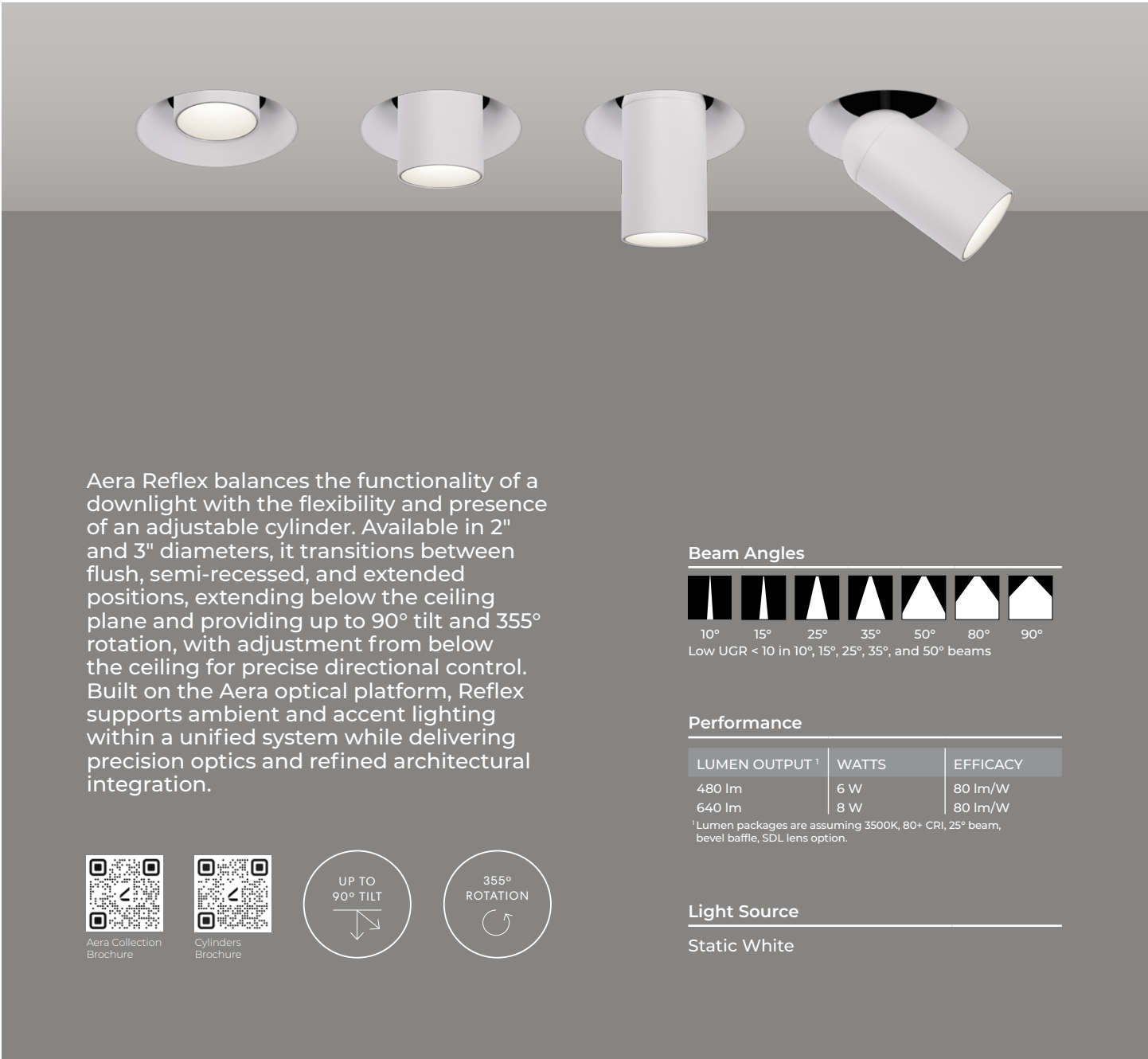

Aera Reflex balances the functionality of a downlight with the flexibility and presence of an adjustable cylinder. Available in 2" and 3" diameters, it transitions between flush, semi-recessed, and extended positions, extending below the ceiling plane and providing up to 90° tilt and 355° rotation, with adjustment from below the ceiling for precise directional control. Built on the Aera optical platform, Reflex supports ambient and accent lighting within a unified system while delivering precision optics and refined architectural integration.

Beam Angles



Performance

LUMEN OUTPUT ¹	WATTS	EFFICACY
480 lm	6 W	80 lm/W
640 lm	8 W	80 lm/W

¹Lumen packages are assuming 3500K, 80+ CRI, 25° beam, bevel baffle, SDL lens option.

Light Source

Static White



Aera Cylinder Family (Refer to other spec sheets)

2" / 3" / 4" / 5" 4" Seal Pendant Pendant Asymmetric Pendant Wall Wash	2" / 3" / 4" / 5" 4" Seal Wall Wall Asymmetric	2" / 3" / 4" / 5" 4" Seal Surface Surface Asymmetric Surface Wall Wash

2" / 3" / 4" Pendant	2" / 3" / 4" Surface

3" Pendant	3" Recessed	3" Surface	3" Wall

2" / 3" Recessed



AERA 2" REFLEX CYLINDER

NEW CONSTRUCTION



Project: _____

Type: _____

Order Guide

1 - Housing

LUMINAIRE ID	TRIM STYLE	LIGHT SOURCE	INSTALLATION TYPE
AE2REFCY		SW	
AE2REFCY - Aera 2" Reflex Cylinder	TRM - Flanged trim TLMP - Trimless drywall mudplate TLMW - Trimless millwork	SW - Static white	NIC - Type Non-IC IC ¹ - Type-IC ¹ See Wattage section for limitations.

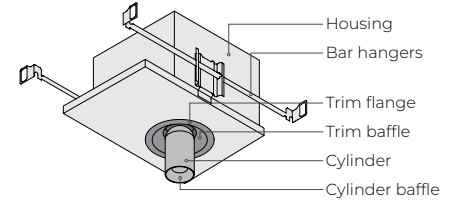

MOUNTING OPTION ²	VOLTAGE	WATTAGE	DIMMING		
ASB - Adjustable standard bar hangers FMB - Flush mount bars ACB - Adjustable commercial bar hangers AHC - Adjustable hat channel bars NA - No bar hangers ² See page 4 for more details.	120V - 120V 277V - 277V UNV - 120V-277V 347V ³ - 347V ³ Available with RD1 driver only. Please consult factory.	6W - 6 W output, up to 480 lm 8W ⁴ - 8 W output, up to 640 lm ⁴ Not available with IC.	INTEGRAL DI - 1% 0-10V ELV ⁵ - ELV 120V TRI ⁵ - TRIAC 120V DA ⁶ - DALI ELD1 - eldoLED 1% ECOdrive 0-10V ⁵ Available with 120V only. ⁶ On-site commissioning is required.		REMOTE ⁷ RD1 - 1% 0-10V RELV ⁸ - ELV 120V RTRI ⁸ - TRIAC 120V RLDE1 ⁹ - Lutron Hi-lume 1% Eco RDA ⁹ - DALI RELD1 - eldoLED 1% ECOdrive 0-10V RELD0 - eldoLED 0.1% SOLOdrive 0-10V RPEQ0 ⁹ - Lutron Hi-lume Premier 0.1% EcoSystem +EB ¹⁰ - Emergency battery ⁷ A remote driver box is provided. ⁸ Available with 120V only. ⁹ On-site commissioning is required. ¹⁰ To specify, add +EB to the selected dimming option, e.g. RD1+EB.

2 - Cylinder & Trim

LUMINAIRE ID	TRIM STYLE Specify same as Housing	TRIM BAFFLE FINISH	TRIM FLANGE FINISH Specify NA for Trimless	CYLINDER FINISH
AE2REFCYL				
AE2REFCYL - Aera 2" Reflex Cylinder	TRM - Flanged trim TLMP - Trimless drywall mudplate TLMW - Trimless millwork	FTMW - Matte white FTMB - Matte black FSPC - Satin silver FSSPC - Matte silver FCHP - Champagne FDBZ - Dark bronze CF# - Custom finish, specify RAL#	FTMW - Matte white FTMB - Matte black FSPC - Satin silver FSSPC - Matte silver FCHP - Champagne FDBZ - Dark bronze CF# - Custom finish, specify RAL# NA - Not applicable	FTMW - Matte white FTMB - Matte black FSPC - Satin silver FSSPC - Matte silver FCHP - Champagne FDBZ - Dark bronze CF# - Custom finish, specify RAL#

CYLINDER BAFFLE STYLE	CYLINDER BAFFLE FINISH	LENS * See page 6 for details	LIGHT SOURCE Specify same as Housing	BEAM
			SW	
BVL - Bevel PHL - Pinhole BVLD - Decorative bevel	FTMW - Matte white FTMB - Matte black FSPC - Satin silver FSSPC - Matte silver FCHP - Champagne FDBZ - Dark bronze CF# - Custom finish, specify RAL#	At baffle (choose 1 option) Specify NOL for Pinhole SDL - Soft diffused lens, Solite FDL - Frosted diffused lens CL - Clear lens NOL - No lens	SW - Static white	10DEG - 10° Very narrow spot 15DEG - 15° Narrow spot 25DEG - 25° Spot 35DEG - 35° Narrow flood 50DEG - 50° Wide flood 80DEG - 80° Very wide flood 90DEG - 90° Open flood

* **LSDL** or **LFDL** at light element cannot be combined with **SDL** or **FDL** at baffle.

COLOR QUALITY	CRI	COLOR TEMPERATURE	ACCESSORIES * See page 6 for details
2STP - 2 Step MacAdam Ellipse 3STP - 3 Step MacAdam Ellipse	80CRI - 80+ CRI 90CRI - 90+ CRI 95CRI - 95+ CRI	22K ¹¹ - 2200K 24K ¹¹ - 2400K 27K - 2700K 30K - 3000K 35K - 3500K 40K - 4000K 50K ¹¹ - 5000K ¹¹ Not available with 95+ CRI.	At light element ^{12,13} (choose up to 2 options) LSDL - Soft diffused lens, Solite LFDL - Frosted diffused lens LS - Linear spread HEX ¹⁴ - Hex louver NA - None ¹² Separate codes with a "*" if more than one is specified, e.g. LSDL+LS. ¹³ LSDL and LFDL cannot be combined. LS and HEX cannot be combined. ¹⁴ Not available with 80°/90° beam options.



AERA 2" REFLEX CYLINDER

NEW CONSTRUCTION



Housing Dimensions

Installation types *

NIC - Type Non-IC

- Minimum plenum height: 7 5/16"
- Clearance between sides of luminaire and parts of building must be 1/2" minimum; clearance to insulating materials to be 3" minimum

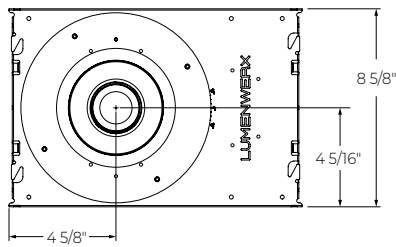
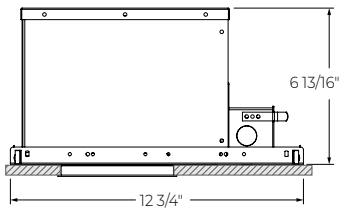

IC - Type-IC

- Minimum plenum height: 7 1/4"
- No setback from insulation required

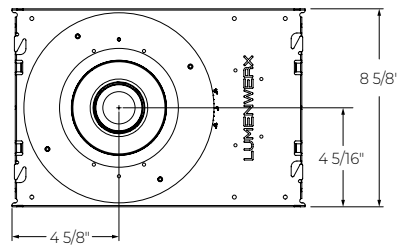
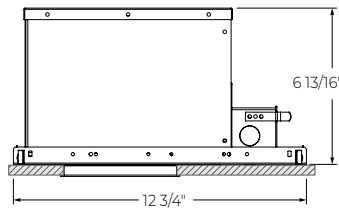

* Bar hangers are not shown in the drawings.

AERA 2" REFLEX CYLINDER

NEW CONSTRUCTION



Mounting Options

ASB - Adjustable Standard Bar Hangers	
	<ul style="list-style-type: none"> • Use in commercial and residential applications. • Suitable for grid ceiling and drywall mounting. • Adjustable to various heights. • Joist spacing: 14" to 24".
FMB - Flush Mount Bars	
	<ul style="list-style-type: none"> • Use in residential applications. • Suitable for wood, metal, and drywall mounting. • Joist spacing: 14" to 24".
ACB - Adjustable Commercial Bar Hangers	
	<ul style="list-style-type: none"> • Use in commercial and residential applications. • Suitable for grid ceiling, drywall, metal, wood, and frame mounting. • Adjustable to various heights. • Fits into C-channel notches in a butterfly bracket. • Joist spacing: 16" to 24". Extensions to 36" and 48" available, consult factory. • T-bar spacing: 24"
AHC - Adjustable Hat Channel Bars	
	<ul style="list-style-type: none"> • Use in commercial and residential applications. • Suitable for wood ceiling and drywall mounting. • Adjustable to various heights. • Fits into C-channel notches in a butterfly bracket. • Hat channel spacing: 24" and 36".

AERA 2" REFLEX CYLINDER

NEW CONSTRUCTION



Cylinder & Baffle Details

BVL Bevel	PHL Pinhole	BVLC Decorative bevel
<p> Cylinder finish Cylinder baffle finish Matte black </p>		

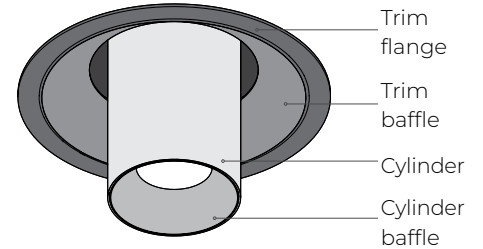

Note: Stem and pivoting arm are matte black.

RETRACTABLE CYLINDER

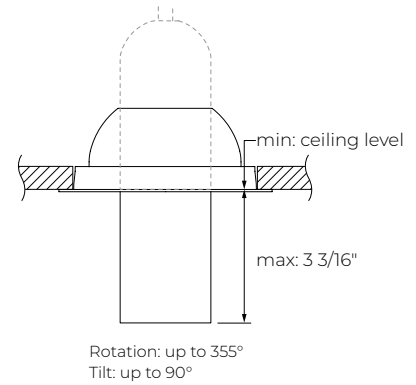

Trim Details

TRM Flanged Trim	TLMF Trimless Drywall Mudplate	TLMW Trimless Millwork
<p> Trim baffle finish Trim flange finish Matte black </p>		

AERA 2" REFLEX CYLINDER

NEW CONSTRUCTION



Lens and Accessories

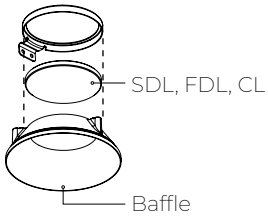
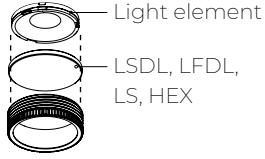

Finishes

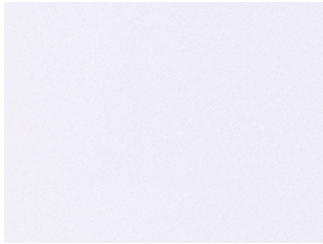

FTMW - Matte white



FTMB - Matte black



FSPC - Satin silver

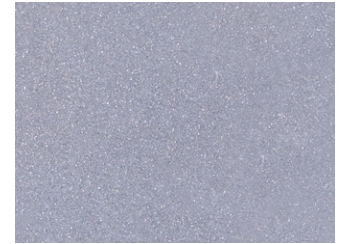

FSSPC - Matte silver



FCHP - Champagne



FDBZ - Dark bronze

AERA 2" REFLEX CYLINDER

NEW CONSTRUCTION



Color Quality

COLOR QUALITY - 3500K	
TM-30 R _r	91
TM-30 R _g	100
CRI	90+
R9	> 50

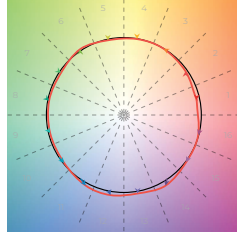

Photometrics

Values calculated based on 3500K, bevel baffle, and SDL lens option.

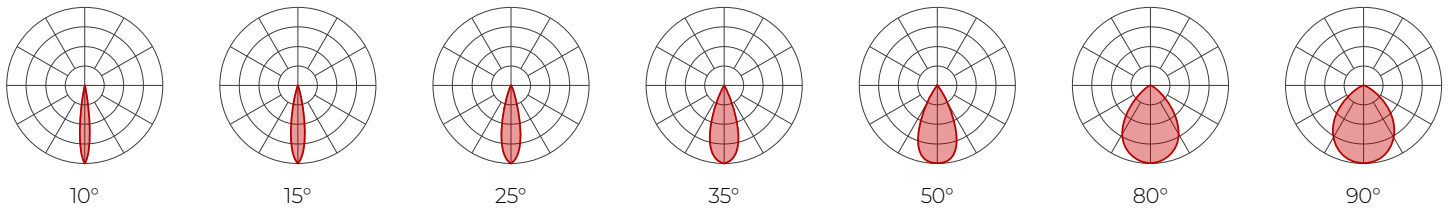

Delivered lumens (LM)

CRI	80+ CRI							90+ CRI							95+ CRI						
	10°	15°	25°	35°	50°	80°	90°	10°	15°	25°	35°	50°	80°	90°	10°	15°	25°	35°	50°	80°	90°
6 W	396	440	480	473	454	409	409	369	411	448	442	424	382	382	285	316	345	340	327	294	294
8 W	528	586	640	631	606	545	545	493	547	598	590	566	510	510	379	422	461	454	435	392	392

Efficacy (LM/W)

CRI	80+ CRI							90+ CRI							95+ CRI						
	10°	15°	25°	35°	50°	80°	90°	10°	15°	25°	35°	50°	80°	90°	10°	15°	25°	35°	50°	80°	90°
6 W	66	73	80	79	76	68	68	62	68	75	74	71	64	64	47	53	58	57	54	49	49
8 W	66	73	80	79	76	68	68	62	68	75	74	71	64	64	47	53	58	57	54	49	49

MULTIPLIERS

Please follow the multiplier tables to ensure correct lumen value. Beams, CCT, baffle styles, baffle colors, lensing, and accessories will change the lumen value.

CCT	BAFFLE STYLE AND COLOR			LENS * (At baffle)		ACCESSORIES * (At light element)	
2200K	Bevel	White	1	SDL - Soft diffused lens, Solite	1	LSDL - Soft diffused lens, Solite	1
2400K		Black	1	FDL - Frosted lens	0.8	LFDL - Frosted lens	0.8
2700K	Pinhole	White	0.92	CL - Clear lens	1.1	LS - Linear spread	0.84
3000K		Black	0.92	NOL - No lens	1.1	HEX - Hex louver	0.86
3500K	Decorative bevel	White	1	* When more than one lens or accessory is specified, multiply together the value of each lens and/or accessory. e.g. NOL + LSDL + LS = 1.1 x 1 x 0.84 = 0.924			
4000K		Black	1				
5000K							



AERA 2" REFLEX CYLINDER

NEW CONSTRUCTION



Technical Specifications

OPTIC

XPoint™ Refraction Technology optics provide precise optical control in a remarkably compact form. Micro optical paths from the chip on board converge and then disperse in precise beam angles, resulting in a crisp and exacting light quality.

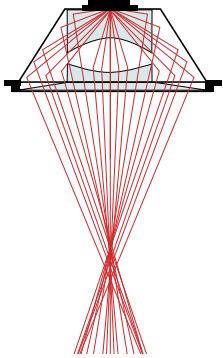

LIGHT SOURCE

Compact COB (Chip-On-Board) LED module, available in 2200K, 2400K, 2700K, 3000K, 3500K, 4000K, and 5000K with a choice of 80+ CRI, 90+ CRI, or 95+ CRI, with elevated R9 value for 90+ CRI and above. Color consistency is maintained to within 2 SDCM. All LEDs have been tested in accordance with IESNA LM-80-08 and the results have shown L80 lumen maintenance greater than 60,000 hours. Absolute product photometry is measured and presented in accordance with IESNA LM-79, unless otherwise indicated.

ELECTRICAL

Unless otherwise specified, dimming down to 1%. At maximum driver load: efficiency > 84%, PF > 0.9, THD < 20%. ELV and TRIAC dimming performance (including minimum dimming percentage) subject to dimmer selection.

Integral: 0-10V, ELV, TRIAC, Lutron Hi-Lume EcoSystem, DALI, eldoLED 0.1% SOLOdrive 0-10V, eldoLED 1% ECOdrive 0-10V

Remote: 0-10V, ELV, TRIAC, Lutron Hi-Lume EcoSystem, DALI, eldoLED 0.1% SOLOdrive 0-10V, eldoLED 1% ECOdrive 0-10V

Emergency battery option: Remotely-installed, long-life, high-temperature, maintenance-free, Bodine Lithium-Ion battery pack with self-test functionality, test switch and charge indicator. IOTA and Fulham options available upon request. Minimum of 90 minutes operation, and recharge time of 24 hours. For fixtures less than 10 W, the battery provides 6 W of emergency light output. For fixtures 10 W and over, the battery provides 10 W.

PoE

Depending on the PoE manufacturer selected, Lumenwerx will install the node in factory as either integral to the luminaire or as a remote module. Factory programming of the PoE node may or may not enable the following functionalities: lumen package, DUO (tunable white), QUADRO (RGBW), emergency battery backup, and sensor integration. These must be addressed and evaluated on a case-by-case basis.

FINISH

Standard powder-coat paint available in matte white, matte black, satin silver, matte silver, champagne, and dark bronze. Custom colors also available (provide RAL #).

CONSTRUCTION

Housing: For new construction, 22 gauge galvanized steel. Open frame or type-IC rated. 18 gauge galvanized steel junction box with ½" trade size knockouts. Adjustable standard, flush mount, adjustable commercial, and adjustable hat channel bar hangers are available as mounting options.

Heat sink: Die-cast aluminum

Trim baffle: Die-cast aluminum mounted with retaining spring clips

Trim style: Trimmed and trimless with mudplate or millwork adapter

Cylinder baffle: Die-cast aluminum

Cylinder baffle style: Bevel, pinhole, and decorative bevel

Cylinder: Die-cast and extruded aluminum

WEIGHT

7.7 lbs - 3.5 kg

LENS AND ACCESSORIES



ENVIRONMENT

Ambient temperature at fixture location shall be within 0°C/32°F - 25°C/77°F, indoor dry or damp as well as outdoor damp use (canopies or marquees).

CERTIFICATIONS

ETL: Rated for indoor dry/damp locations. Conforms to UL Standard 1598 and certified to CAN/CSA Standard C22.2 No. 250.0.

IC rated: Suitable for direct contact with insulation when specified with IC installation type options.

AERA 2" REFLEX CYLINDER

NEW CONSTRUCTION



WARRANTY

Lumenwerx provides a five-year limited warranty on electrical and mechanical performance of the luminaires, including the LED boards, drivers, and auxiliary electronics. Lumenwerx will repair or replace defective luminaires or components at our discretion, provided they have been installed and operated in accordance with our specifications. Other limitations apply, please refer to the full warranty on our website.